



University of  
**Southern**  
**Queensland**

# UniSQ Brisbane

293 Queen Street, Brisbane City

Venue brochure

# UniSQ Brisbane

## Event space and venue hire

UniSQ Brisbane is positioned in Brisbane's most sought-after location in a landmark heritage building at 293 Queen Street – a five-minute walk through ANZAC and Post Office Squares to Central Station.

Spread across three levels, the facility provides function spaces that can be configured in multiple formats to accommodate formal meetings and external events such as conferences, award ceremonies, lectures and cocktail functions. The facility can accommodate up to 100 people seated lecture-style or for formal sit-down lunches/dinners.

UniSQ Brisbane features a coffee shop with an extensive lounge on the ground floor – providing a central meeting place for visitors and guests.

## The venue is suitable for

- Workshops and training
- Conferences and seminars
- Boardroom meetings and AGM's
- Forums
- Networking and corporate events



## UniSQ Brisbane is equipped with the following facilities

- Flexible event / meeting spaces
- Boardroom
- Reception and registration desk
- Community lounge and outdoor terrace
- Videoconference facilities
- Teleconference facilities
- Functions coordinator
- WiFi

## Getting here

- **By Train:** 5-minute walk to Central Station in Ann Street through Anzac Square and Post Office Square.
- **By Car:** A 1-minute walk from Secure Parking at MacArthur Central or Queens Plaza parking provides cost-effective and close parking.
- **Taxi/Uber Access:** Taxi and Uber ranks are located outside the building on Queen Street.
- **Bus Access:** Numerous bus stops are located near the building along Queen and Creek streets.

## Booking enquiries

A member of our team will be pleased to give you a tour of our facility upon request. For event or event booking enquiries, please contact our events team via email at [brisbaneevents@unisq.edu.au](mailto:brisbaneevents@unisq.edu.au)



# Room capacities

Fees include a lectern, microphone, video and teleconference facilities and Wi-Fi.

The setup of the function rooms can be adjusted to suit your needs and setup requirements.

Room	Layout and Capacity					
	Size (m <sup>2</sup> )	Pod	Boardroom	Theatre	Cocktail	U-shape
<b>Ground Floor</b>						
Brisbane Room One	124	48	-	70	-	24
Brisbane Room Two	70	24	-	30	-	16
The Auditorium	194	72	-	100	150	-
Whole Ground Floor (walls open)	340	-	-	100	150	-
<b>Level Six</b>						
Seminar Room One	68	24	25	40	-	16
Seminar Room Two	65	24	25	40	-	16
Seminar Room Three	86	42	-	70	-	20
Meeting Room One	21	-	8	-	-	-
Meeting Room Three	20	-	8	-	-	-
<b>Level Seven</b>						
Community Lounge/Terrace	149	-	-	-	70	-
The Boardroom	54	-	18	-	-	-
Boardroom/Lounge	157	-	-	-	90	-

# Floorplan – Ground floor

(Entry via Queen Street)

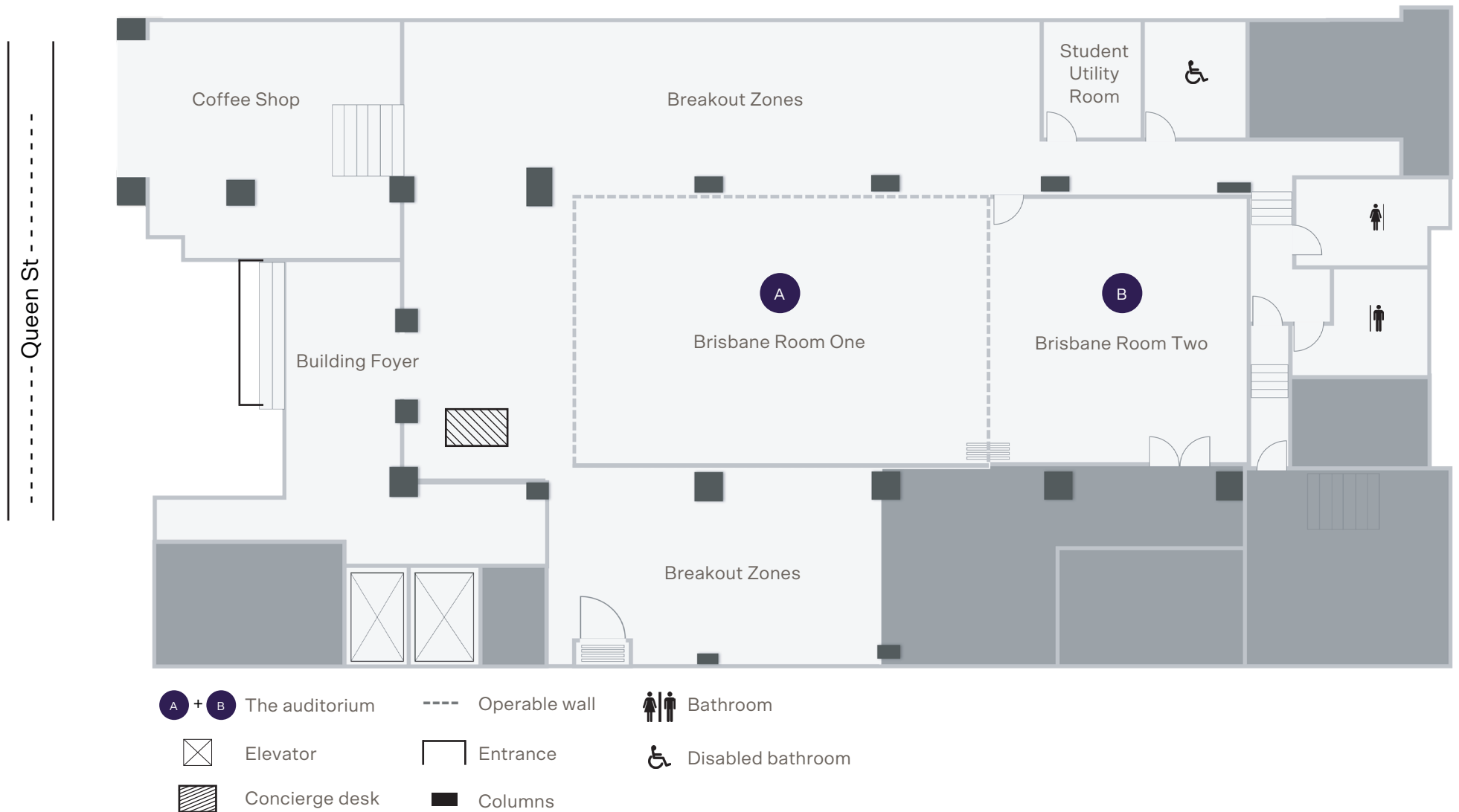

# Floorplan – Level 6

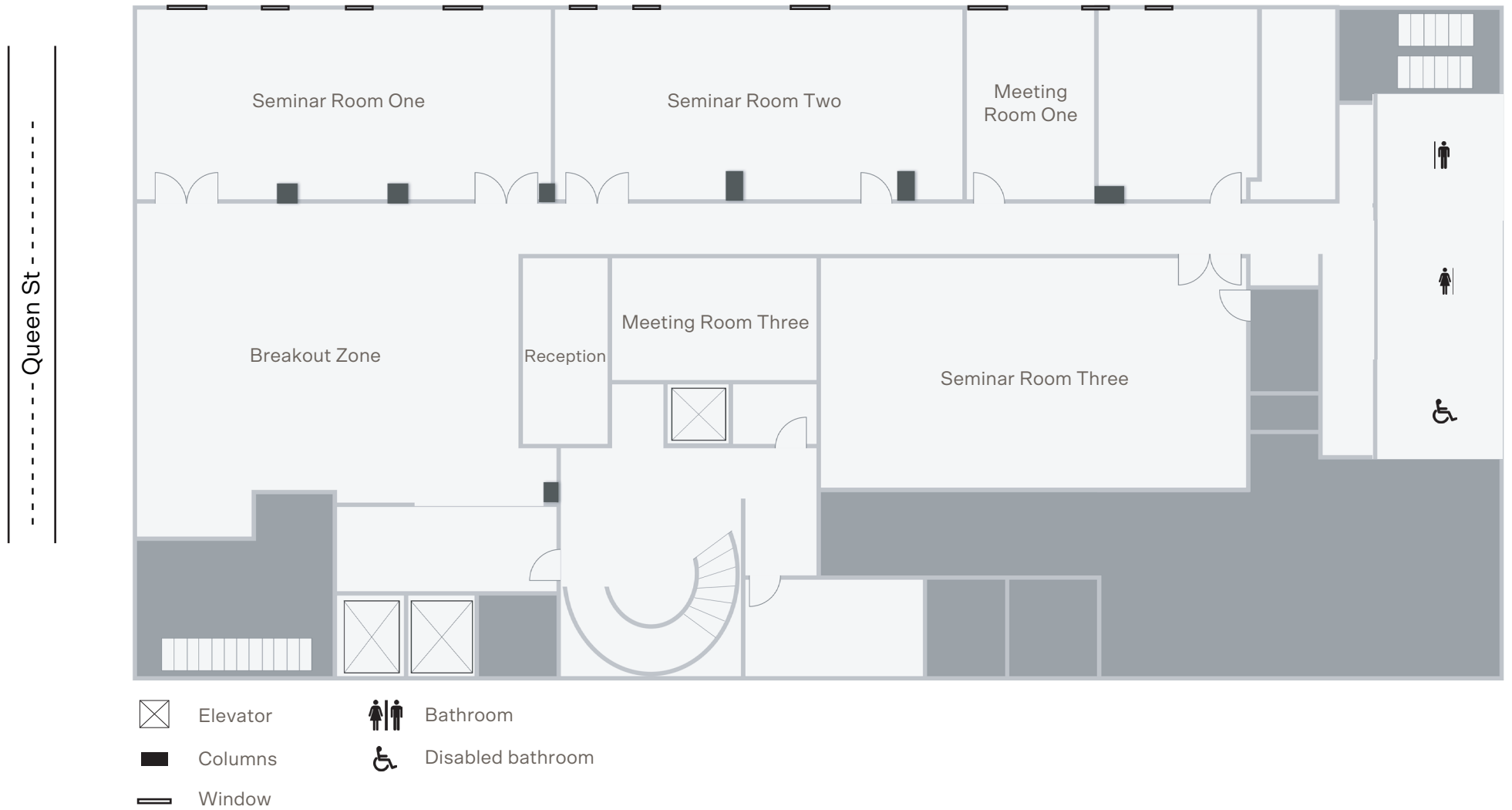

# Floorplan - Level 7





University of  
**Southern  
Queensland**

## **UniSQ Brisbane**

**T:** +61 7 3470 4999

**E:** [brisbaneevents@unisq.edu.au](mailto:brisbaneevents@unisq.edu.au)

**W:** [unisq.edu.au/brisbane](http://unisq.edu.au/brisbane)

**A:** 293 Queen Street, Brisbane City

Visit the website

